

Setting Up Your Dell™ Cordless Mouse, Keyboard, and USB Receiver



Español Configuración del teclado, mouse y receptor USB inalámbricos Dell™

繁體中文 設置 Dell™ Cordless 滑鼠、鍵盤與 USB 接收器

日本語 Dell™ コードレス マウス、キーボード、USB レシーバの設定

Português Configurando o mouse sem-fio, o teclado e o receptor USB Dell™

한국어 Dell™ 무선 마우스, 키보드 및 USB 리시버 설치

Français Configuration de votre ensemble souris, clavier et récepteur USB Dell™

CAUTION:

Before you set up and operate your Dell™ device, see the safety instructions that shipped with your product and the documentation for a complete list of features.

PRECAUCIÓN:

Antes de configurar y usar el dispositivo Dell™, vea las instrucciones de seguridad que se entregan con el producto y la documentación para obtener una lista completa de funciones.

注意:

在設置與運行 Dell™ 設備之前，請閱讀產品隨附的安全說明，並查閱隨附文件，了解完整功能。

注意:

在設定與運行 Dell™ 裝置之前，請閱讀產品隨附的安全說明，並查閱隨附文件，瞭解完整功能。

警告:

Dell™ デバイスを設定して操作する前に、製品に同梱の安全性についての説明と説明書で全機能について確認してください。

AVISO:

Antes de configurar e operar seu dispositivo Dell™, consulte as instruções de segurança e a documentação fornecidas com o produto para obter a lista completa de recursos.

주의:

Dell™ 장치를 설치 및 작동하기 전에 제품과 함께 제공되는 안전 지침 및 기능 전체 목록에 대한 문서 참조하십시오.

ATTENTION:

Avant de configurer votre dispositif Dell™ et de l'utiliser, consultez les consignes de sécurité qui l'accompagnent, ainsi que sa documentation, afin de connaître la liste complète des fonctionnalités.

1 Verify the contents of your package.



NOTE: There is no need to pair the keyboard and mouse with the USB receiver. They are already pre-paired.

NOTA: No es necesario emparejar el teclado y el mouse con el receptor USB. Ya están emparejados de fábrica.

注意: 不需要使用 USB 接收器配對鍵盤與鼠標，他們已預先配對。

注意: 不需要使用 USB 接收器配對鍵盤與滑鼠，他們已預先配對。

メモ: キーボードとマウスは USB レシーバと既にペアリングされているため、改めてペアリングする必要はありません。

REMARK: Não é preciso conectar o teclado e o mouse com o receptor USB. Eles já vêm preparados.

REMARK: Não é preciso conectar o teclado e o mouse com o receptor USB. Eles já vêm preparados.

Compruebe el contenido del paquete.
Teclado / Mouse
Receptor USB
Pilas AA (4)

梱包の内容を確認します。
キーボード
マウス
USB レシーバ
AA 電池 (4 本)

확인항목 내보내주세요.
키보드
마우스
USB 리시버
AA 배터리 (4 개)

Verifique o conteúdo do pacote.
Teclado
Mouse
Receptor USB
Baterias AA (4)

2 Insert the USB receiver into any available USB port on your computer.

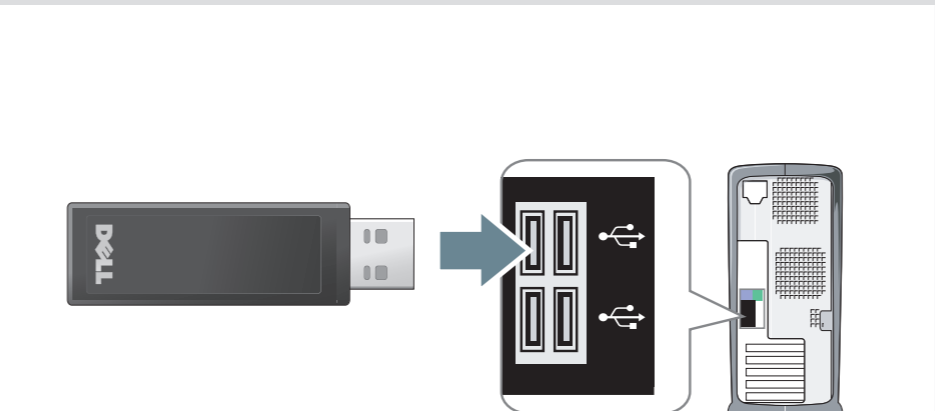

Introduza el mini-receptor USB en un puerto USB disponible en la computadora.

將 USB 連接器插入計算機的可用 USB 端口。

將 USB 連接器插入電腦的可用 USB 埠。

USB レシーバをコンピュータの USB ポートに挿入します。

Insira o receptor USB em uma porta USB disponível no computador.

USB 리시버를 컴퓨터에서 사용 가능한 USB 포트에 연결합니다.

Branchez le récepteur dans l'un des ports USB disponibles de l'ordinateur.

4 Move the mouse to see if the mouse is working.

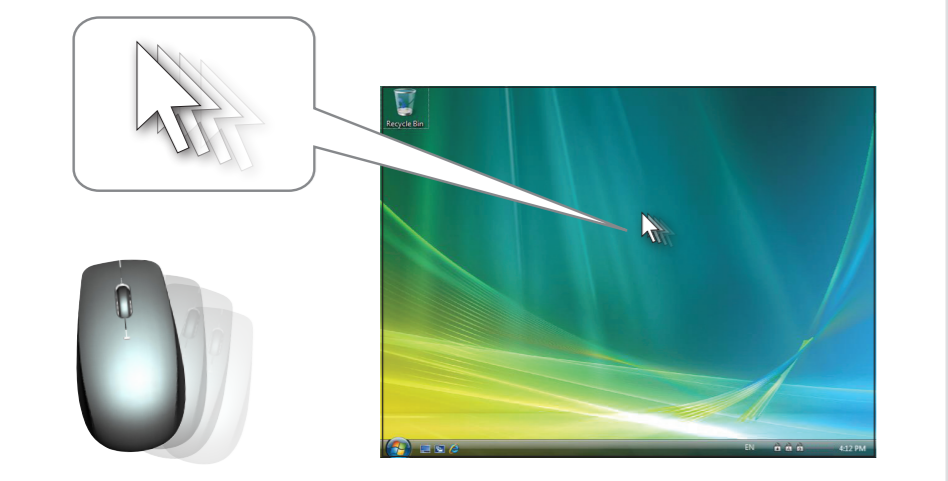

Mueva el mouse para comprobar si funciona.

移動鼠標，檢查鼠標是否工作。

移動滑鼠，檢查滑鼠是否工作。

Mova o mouse para verificar se ele está funcionando.

마우스를 움직여 마우스가 작동하는지 확인합니다.

Déplacez le souris pour vérifier qu'elle fonctionne.

5 Install the batteries in your keyboard.

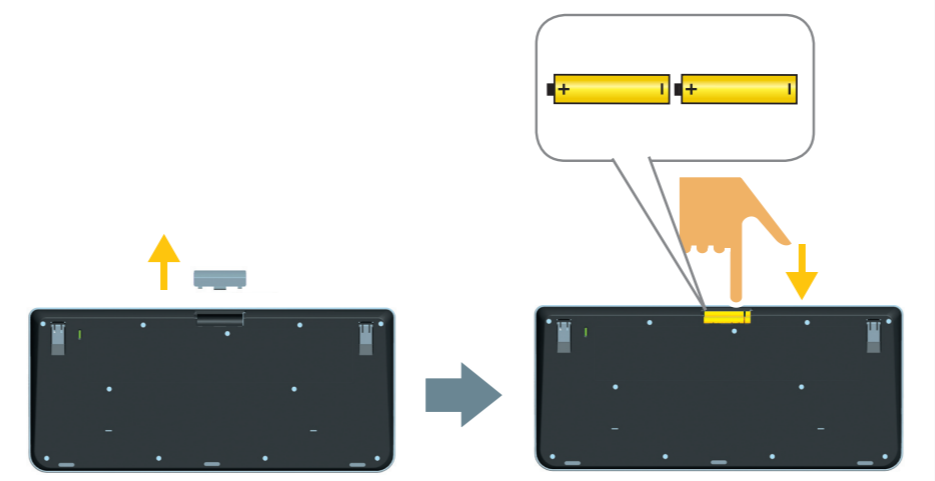

Coloque las pilas en el teclado.

安裝鍵盤電池。

安裝鍵盤電池。

キーボードに電池をセットします。

Instale as baterias no teclado.

키보드에 배터리를 장착합니다.

Installez les piles dans le clavier.

3 Install the batteries in your mouse.

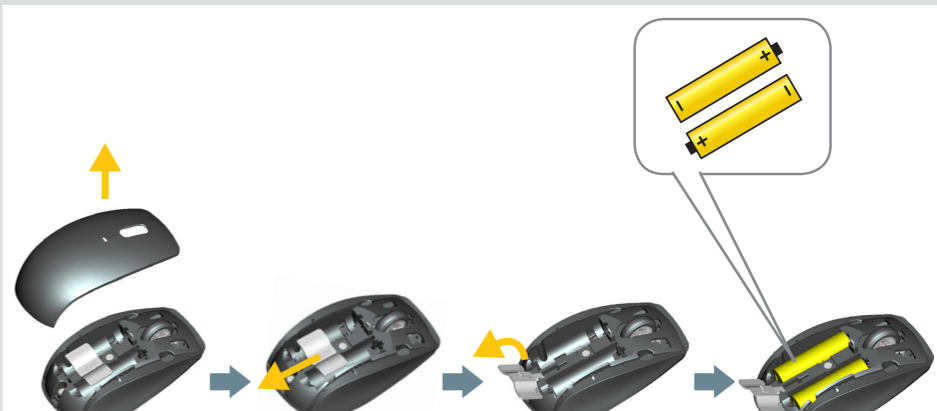

Coloque las pilas en el mouse.

安裝鼠標電池。

安裝滑鼠電池。

マウスに電池をセットします。

Instale as baterias no mouse.

마우스에 배터리를 장착합니다.

Installez les piles dans le souris.

Press the "Windows" key to see if the keyboard is working.

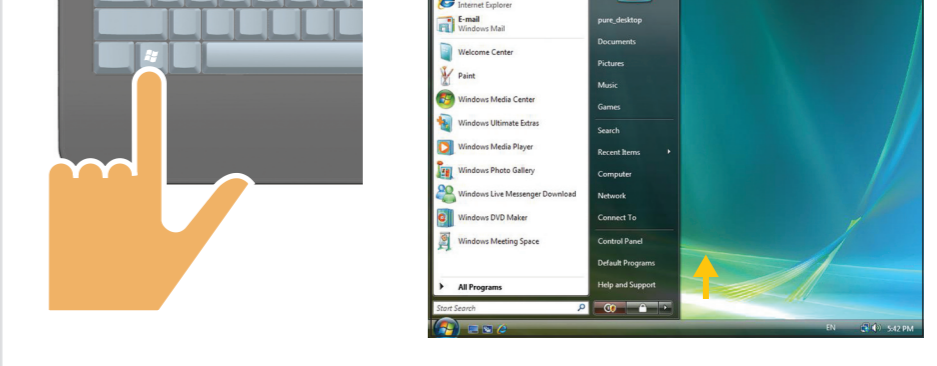

Pañe la tecla "Windows" para comprobar si el teclado funciona.

按 "Windows" 鍵，檢查鍵盤是否工作。

按 "Windows" 鍵，檢查鍵盤是否工作。

Windows キーを押して、キーボードが機能しているか確認します。

Pressione a tecla "Windows" para verificar se o teclado está funcionando.

Windows 키를 눌러 키보드가 작동하는지 확인합니다.

Appuyez sur la touche Windows pour vérifier que le clavier fonctionne.

Getting to Know Your Cordless Mouse, Keyboard, and USB Receiver

Español Presentación del teclado, mouse y receptor USB inalámbricos

繁體中文 了解鼠標、鍵盤與 USB 接收器

日本語 コードレス マウス、キーボード、USB レシーバについて理解する

Português Conhecendo o mouse sem-fio, o teclado e o receptor USB

한국어 무선 마우스, 키보드 및 리시버 알아 보기

Français Présentation de la souris sans fil, du clavier et du récepteur USB



Green (solid) The Green (solid) indicator appears for a few seconds after you install the batteries.

Green (flashing) The Cordless Discovery Indicator appears after you press the "Wireless Sync" button on the bottom of the receiver. The light indicates the device's readiness to be found by the receiver.

Green (solid) The Connection Established Indicator appears when you press the "Wireless Sync" button on the receiver followed by the "Wireless Sync" button on the keyboard. The indicator turns off after a few seconds.

Green (flashing) The Low Battery Indicator appears when replacement of the batteries is required.

Green (flashing) The Cordless Discovery Indicator appears after you press the "Wireless Sync" button on the bottom of the mouse. The light indicates the device's readiness to be found by the receiver.

Green (solid) The Connection Established Indicator appears when you press the "Wireless Sync" button on the receiver followed by the "Wireless Sync" button on the keyboard.

Green (flashing) The Low Battery Indicator appears when replacement of the batteries is required.

Green (flashing) The Cordless Discovery Indicator appears after you press the "Wireless Sync" button on the bottom of the mouse. The light indicates the device's readiness to be found by the receiver.

Green (solid) The Connection Established Indicator appears when you press the "Wireless Sync" button on the receiver followed by the "Wireless Sync" button on the keyboard.

Green (flashing) The Low Battery Indicator appears when replacement of the batteries is required.

Green (flashing) The Cordless Discovery Indicator appears after you press the "Wireless Sync" button on the bottom of the mouse. The light indicates the device's readiness to be found by the receiver.

Green (solid) The Connection Established Indicator appears when you press the "Wireless Sync" button on the receiver followed by the "Wireless Sync" button on the keyboard.

Green (flashing) The Low Battery Indicator appears when replacement of the batteries is required.

Green (flashing) The Cordless Discovery Indicator appears after you press the "Wireless Sync" button on the bottom of the mouse. The light indicates the device's readiness to be found by the receiver.

Green (solid) The Connection Established Indicator appears when you press the "Wireless Sync" button on the receiver followed by the "Wireless Sync" button on the keyboard.

Green (flashing) The Low Battery Indicator appears when replacement of the batteries is required.

Green (flashing) The Cordless Discovery Indicator appears after you press the "Wireless Sync" button on the bottom of the mouse. The light indicates the device's readiness to be found by the receiver.

Green (solid) The Connection Established Indicator appears when you press the "Wireless Sync" button on the receiver followed by the "Wireless Sync" button on the keyboard.

Green (flashing) The Low Battery Indicator appears when replacement of the batteries is required.

Green (flashing) The Cordless Discovery Indicator appears after you press the "Wireless Sync" button on the bottom of the mouse. The light indicates the device's readiness to be found by the receiver.

Green (solid) The Connection Established Indicator appears when you press the "Wireless Sync" button on the receiver followed by the "Wireless Sync" button on the keyboard.

Green (flashing) The Low Battery Indicator appears when replacement of the batteries is required.

Green (flashing) The Cordless Discovery Indicator appears after you press the "Wireless Sync" button on the bottom of the mouse. The light indicates the device's readiness to be found by the receiver.

Green (solid) The Connection Established Indicator appears when you press the "Wireless Sync" button on the receiver followed by the "Wireless Sync" button on the keyboard.

Green (flashing) The Low Battery Indicator appears when replacement of the batteries is required.

Green (flashing) The Cordless Discovery Indicator appears after you press the "Wireless Sync" button on the bottom of the mouse. The light indicates the device's readiness to be found by the receiver.

Green (solid) The Connection Established Indicator appears when you press the "Wireless Sync" button on the receiver followed by the "Wireless Sync" button on the keyboard.

Green (flashing) The Low Battery Indicator appears when replacement of the batteries is required.

Green (flashing) The Cordless Discovery Indicator appears after you press the "Wireless Sync" button on the bottom of the mouse. The light indicates the device's readiness to be found by the receiver.

Green (solid) The Connection Established Indicator appears when you press the "Wireless Sync" button on the receiver followed by the "Wireless Sync" button on the keyboard.

Green (flashing) The Low Battery Indicator appears when replacement of the batteries is required.

Green (flashing) The Cordless Discovery Indicator appears after you press the "Wireless Sync" button on the bottom of the mouse. The light indicates the device's readiness to be found by the receiver.

Green (solid) The Connection Established Indicator appears when you press the "Wireless Sync" button on the receiver followed by the "Wireless Sync" button on the keyboard.

Green (flashing) The Low Battery Indicator appears when replacement of the batteries is required.

Green (flashing) The Cordless Discovery Indicator appears after you press the "Wireless Sync" button on the bottom of the mouse. The light indicates the device's readiness to be found by the receiver.

Green (solid) The Connection Established Indicator appears when you press the "Wireless Sync" button on the receiver followed by the "Wireless Sync" button on the keyboard.

Green (flashing) The Low Battery Indicator appears when replacement of the batteries is required.

Green (flashing) The Cordless Discovery Indicator appears after you press the "Wireless Sync" button on the bottom of the mouse. The light indicates the device's readiness to be found by the receiver.

Green (solid) The Connection Established Indicator appears when you press the "Wireless Sync" button on the receiver followed by the "Wireless Sync" button on the keyboard.

Green (flashing) The Low Battery Indicator appears when replacement of the batteries is required.

Green (flashing) The Cordless Discovery Indicator appears after you press the "Wireless Sync" button on the bottom of the mouse. The light indicates the device's readiness to be found by the receiver.

Green (solid) The Connection Established Indicator appears when you press the "Wireless Sync" button on the receiver followed by the "Wireless Sync" button on the keyboard.

Green (flashing) The Low Battery Indicator appears when replacement of the batteries is required.

Green (flashing) The Cordless Discovery Indicator appears after you press the "Wireless Sync" button on the bottom of the mouse. The light indicates the device's readiness to be found by the receiver.

Green (solid) The Connection Established Indicator appears when you press the "Wireless Sync" button on the receiver followed by the "Wireless Sync" button on the keyboard.

Green (flashing) The Low Battery Indicator appears when replacement of the batteries is required.

Green (flashing) The Cordless Discovery Indicator appears after you press the "Wireless Sync" button on the bottom of the mouse. The light indicates the device's readiness to be found by the receiver.

Green (solid) The Connection Established Indicator appears when you press the "Wireless Sync" button on the receiver followed by the "Wireless Sync" button on the keyboard.

Green (flashing) The Low Battery Indicator appears when replacement of the batteries is required.

Green (flashing) The Cordless Discovery Indicator appears after you press the "Wireless Sync" button on the bottom of the mouse. The light indicates the device's readiness to be found by the receiver.

Green (solid) The Connection Established Indicator appears when you press the "Wireless Sync" button on the receiver followed by the "Wireless Sync" button on the keyboard.

Green (flashing) The Low Battery Indicator appears when replacement of the batteries is required.

Green (flashing) The Cordless Discovery Indicator appears after you press the "Wireless Sync" button on the bottom of the mouse. The light indicates the device's readiness to be found by the receiver.

Green (solid) The Connection Established Indicator appears when you press the "Wireless Sync" button on the receiver followed by the "Wireless Sync" button on the keyboard.

Green (flashing) The Low Battery Indicator appears when replacement of the batteries is required.

Green (flashing) The Cordless Discovery Indicator appears after you press the "Wireless Sync" button on the bottom of the mouse. The light indicates the device's readiness to be found by the receiver.

Green (solid) The Connection Established Indicator appears when you press the "Wireless Sync" button on the receiver followed by the "Wireless Sync" button on the keyboard.

Green (flashing) The Low Battery Indicator appears when replacement of the batteries is required.

Green (flashing) The Cordless Discovery Indicator appears after you press the "Wireless Sync" button on the bottom of the mouse. The light indicates the device's readiness to be found by the receiver.

Green (solid) The Connection Established Indicator appears when you press the "Wireless Sync" button on the receiver followed by the "Wireless Sync" button on the keyboard.

Green (flashing) The Low Battery Indicator appears when replacement of the batteries is required.

Green (flashing) The Cordless Discovery Indicator appears after you press the "Wireless Sync" button on the bottom of the mouse. The light indicates the device's readiness to be found by the receiver.

Green (solid) The Connection Established Indicator appears when you press the "Wireless Sync" button on the receiver followed by the "Wireless Sync" button on the keyboard.

Green (flashing) The Low Battery Indicator appears when replacement of the batteries is required.

Green (flashing) The Cordless Discovery Indicator appears after you press the "Wireless Sync" button on the bottom of the mouse. The light indicates the device's readiness to be found by the receiver.

Green (solid) The Connection Established Indicator appears when you press the "Wireless Sync" button on the receiver followed by the "Wireless Sync" button on the keyboard.

Green (flashing) The Low Battery Indicator appears when replacement of the batteries is required.

Green (flashing) The Cordless Discovery Indicator appears after you press the "Wireless Sync" button on the bottom of the mouse. The light indicates the device's readiness to be found by the receiver.

Green (solid) The Connection Established Indicator appears when you press the "Wireless Sync" button on the receiver followed by the "Wireless Sync" button on the keyboard.

Green (flashing) The Low Battery Indicator appears when replacement of the batteries is required.

Green (flashing) The Cordless Discovery Indicator appears after you press the "Wireless Sync" button on the bottom of the mouse. The light indicates the device's readiness to be found by the receiver.

Green (solid) The Connection Established Indicator appears when you press the "Wireless Sync" button on the receiver followed by the "Wireless Sync" button on the keyboard.

Green (flashing) The Low Battery Indicator appears when replacement of the batteries is required.

Green (flashing) The Cordless Discovery Indicator appears after you press the "Wireless Sync" button on the bottom of the mouse. The light indicates the device's readiness to be found by the receiver.

Green (solid) The Connection Established Indicator appears when you press the "Wireless Sync" button on the receiver followed by the "Wireless Sync" button on the keyboard.

Green (flashing) The Low Battery Indicator appears when replacement of the batteries is required.

Green (flashing) The Cordless Discovery Indicator appears after you press the "Wireless Sync" button on the bottom of the mouse. The light indicates the device's readiness to be found by the receiver.

Green (solid) The Connection Established Indicator appears when you press the "Wireless Sync" button on the receiver followed by the "Wireless Sync" button on the keyboard.

Green (flashing) The Low Battery Indicator appears when replacement of the batteries is required.

Green (flashing) The Cordless Discovery Indicator appears after you press the "Wireless Sync" button on the bottom of the mouse. The light indicates the device's readiness to be found by the receiver.

Green (solid) The Connection Established Indicator appears when you press the "Wireless Sync" button on the receiver followed by the "Wireless Sync" button on the keyboard.

Green (flashing) The Low Battery Indicator appears when replacement of the batteries is required.

Green (flashing) The Cordless Discovery Indicator appears after you press the "Wireless Sync" button on the bottom of the mouse. The light indicates the device's readiness to be found by the receiver.

Green (solid) The Connection Established Indicator appears when you press the "Wireless Sync" button on the receiver followed by the "Wireless Sync" button on the keyboard.

Green (flashing) The Low Battery Indicator appears when replacement of the batteries is required.

Green (flashing) The Cordless Discovery Indicator appears after you press the "Wireless Sync" button on the bottom of the mouse. The light indicates the device's readiness to be found by the receiver.

Green (solid) The Connection Established Indicator appears when you press the "Wireless Sync" button on the receiver followed by the "Wireless Sync" button on the keyboard.

Green (flashing) The Low Battery Indicator appears when replacement of the batteries is required.

Green (flashing) The Cordless Discovery Indicator appears after you press the "Wireless Sync" button on the bottom of the mouse. The light indicates the device's readiness to be found by the receiver.

Green (solid) The Connection Established Indicator appears when you press the "Wireless Sync" button on the receiver followed by the "Wireless Sync" button on the keyboard.

Green (flashing) The Low Battery Indicator appears when replacement of the batteries is required.

Green (flashing) The Cordless Discovery Indicator appears after you press the "Wireless Sync" button on the bottom of the mouse. The light indicates the device's readiness to be found by the receiver.

Green (solid) The Connection Established Indicator appears when you press the "Wireless Sync" button on the receiver followed by the "Wireless Sync" button on the keyboard.

Green (flashing) The Low Battery Indicator appears when replacement of the batteries is required.

Green (flashing) The Cordless Discovery Indicator appears after you press the "Wireless Sync" button on the bottom of the mouse. The light indicates the device's readiness to be found by the receiver.

Green (solid) The Connection Established Indicator appears when you press the "Wireless Sync" button on the receiver followed by the "Wireless Sync" button on the keyboard.

Green (flashing) The Low Battery Indicator appears when replacement of the batteries is required.

Green (flashing) The Cordless Discovery Indicator appears after you press the "Wireless Sync" button on the bottom of the mouse. The light indicates the device's readiness to be found by the receiver.

Green (solid) The Connection Established Indicator appears when you press the "Wireless Sync" button on the receiver followed by the "Wireless Sync" button on the keyboard.

Green (flashing) The Low Battery Indicator appears when replacement of the batteries is required.

Green (flashing) The Cordless Discovery Indicator appears after you press the "Wireless Sync" button on the bottom of the mouse. The light indicates the device's readiness to be found by the receiver.

Green (solid) The Connection Established Indicator appears when you press the "Wireless Sync" button on the receiver followed by the "Wireless Sync" button on the keyboard.

Green (flashing) The Low Battery Indicator appears when replacement of the batteries is required.

Green (flashing) The Cordless Discovery Indicator appears after you press the "Wireless Sync" button on the bottom of the mouse. The light indicates the device's readiness to be found by the receiver.

Green (solid) The Connection Established Indicator appears when you press the "Wireless Sync" button on the receiver followed by the "Wireless Sync" button on the keyboard.

Green (flashing) The Low Battery Indicator appears when replacement of the batteries is required.

Green (flashing) The Cordless Discovery Indicator appears after you press the "Wireless Sync" button on the bottom of the mouse. The light indicates the device's readiness to be found by the receiver.

Green (solid) The Connection Established Indicator appears when you press the "Wireless Sync" button on the receiver followed by the "Wireless Sync" button on the keyboard.

Green (flashing) The Low Battery Indicator appears when replacement of the batteries is required.

Green (flashing) The Cordless Discovery Indicator appears after you press the "Wireless Sync" button on the bottom of the mouse. The light indicates the device's readiness to be found by the receiver.

Green (solid) The Connection Established Indicator appears when you press the "Wireless Sync" button on the receiver followed by the "Wireless Sync" button on the keyboard.

Green (flashing) The Low Battery Indicator appears when replacement of the batteries is required.

Green (flashing) The Cordless Discovery Indicator appears after you press the "Wireless Sync" button on the bottom of the mouse. The light indicates the device's readiness to be found by the receiver.

Green (solid) The Connection Established Indicator appears when you press the "Wireless Sync" button on the receiver followed by the "Wireless Sync" button on the keyboard.

Green (flashing) The Low Battery Indicator appears when replacement of the batteries is required.

Green (flashing) The Cordless Discovery Indicator appears after you press the "Wireless Sync" button on the bottom of the mouse. The light indicates the device's readiness to be found by the receiver.

Green (solid) The Connection Established Indicator appears when you press the "Wireless Sync" button on the receiver followed by the "Wireless Sync" button on the keyboard.